



655 Eisenhower Drive  
Owatonna, MN 55060-0995 USA  
Phone: (507) 455-7000  
Tech. Serv.: (800) 533-6127  
Fax: (800) 955-8329  
Order Entry: (800) 533-6127  
Fax: (800) 283-8665  
International Sales: (507) 455-7290  
Fax: (507) 455-7063

Form No. 102751

Parts List &  
Operating Instructions for:

1591A

## Portable Air Lift Jack/Support Stand

Max. Capacity: 10 Tons at 200 PSI

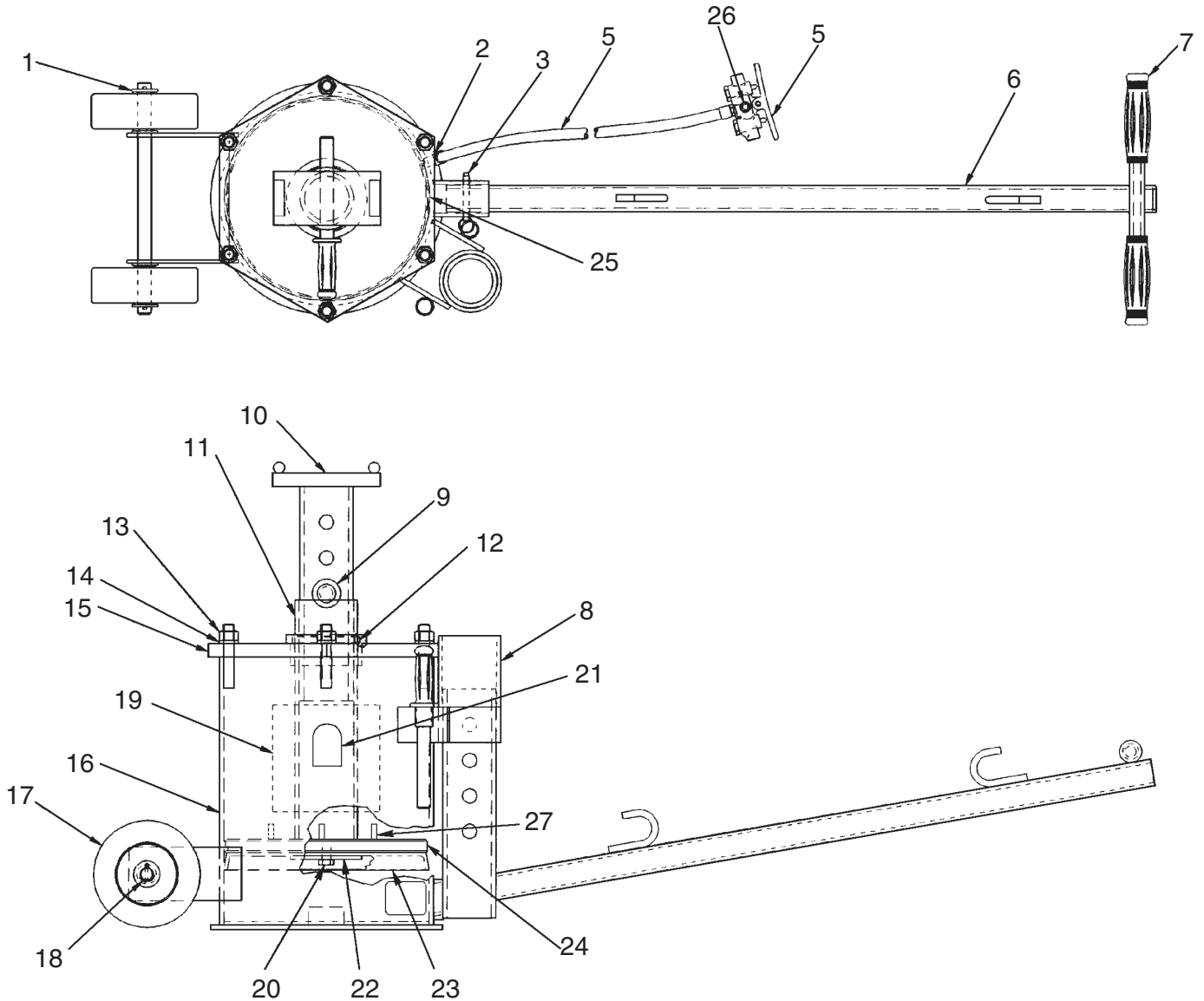

Sheet No. 1 of 2

Issue Date: Rev. D, August 3, 2012

Item No.	Part No.	No. Req'd	Description
4	217354	1	Hydraulic Hose
5	217335	1	Air Valve
6	48351	1	Assembly Handle
8	48384	1	Extension Tube
9	313881	2	Pin
10	48349	1	Saddle Tube
11	440223	1	Piston Assembly
12	515360	1	Wear Ring
15	54425	1	Cover Plate
16	62283	1	Body Weldment
17	12119-1	2	Wheel (6" dia.)
18	217176	2	Cotter Pin
21	216703	1	Made in USA Decal
23	217164	1	U-cup Seal
24	217175	3 ft.	Bearing Strip

#### Hardware Kit 564176

Item No.	No. Req'd.	Description
1	4	Washer (for 3/4" bolt)
2	1	45° Fitting
3	1	Cotterless Hitch Pin
7	2	Handle Grip
13	6	Hex Nut (5/8-11; torque to 80-110 ft. lbs.)
14	6	Lock Washer (for 5/8" bolt)
19	1	Part Number Decal
20	1	Hex Hd. Cap Screw (1/2-13 x 1-1/4" lg.)
22	1	Washer
25	1	Warning Decal
26	1	Plug
27	4	Pin

## Valve and Hose Kit 564177

Item No.	No. Req'd.	Description
4	1	Hydraulic Hose
5	1	Air Valve

## Wheel Kit 564178

Item No.	No. Req'd.	Description
17	2	Wheel (6" dia.)
18	2	Cotter Pin

Refer to any operating instructions included with the product for detailed information about operation, testing, disassembly, reassembly, and preventive maintenance.

Items found in this parts list have been carefully tested and selected by OTC. **Therefore: Use only genuine OTC replacement parts.**

Additional questions can be directed to our Technical Service Dept.

## Safety Precautions



**Caution:** Failure to heed the following warnings can result in loss of load, damage to equipment, and/or failure resulting in personal injury or property damage:



- Read and understand the safety precautions and operating instructions before using the air lift jack. If the operator cannot read English, operating instructions and safety precautions must be read and discussed in the operator's native language.



- Si el operador no puede leer el inglés, las instrucciones de operación y las precauciones de seguridad deberán leerse y comentarse en el idioma nativo del operador. Si l'utilisateur ne peut lire l'anglais, les instructions et les consignes de sécurité doivent lui être expliquées dans sa langue maternelle.

- Wear eye protection that meets ANSI Z87.1 and OSHA standards.
- Do not modify the air lift jack or use attachments unless approved or supplied by OTC.
- A load must never exceed the maximum capacity of the jack.
- Before lifting a vehicle, release the parking brake, place the gear selector in neutral, and chock the wheels at the opposite end.
- Use the jack on a hard, level surface.
- Stay clear of a raised load.
- Release pressure SLOWLY.

## Operating Instructions

1. Before lifting a vehicle, release the parking brake, place the gear selector in neutral, and chock the wheels at the opposite end.
2. Position the air lift jack under the vehicle frame.
3. Raise lifting saddle and insert pin into hole that retains saddle closest to lifting point.
4. Set shop air pressure at 200 psi or less. Connect a shop air hose to the fitting on the jack's control valve.
5. Using the control valve lever, apply shop air until the jack saddle meets the load to be raised. Lifting saddle must cradle the lifting point by nesting around the frame, bumper, or bed. See Figure 1.
6. Continue applying shop air to raise the load to desired height. Then insert second pin into hole on piston tube and SLOWLY release pressure until load comes to rest on pin.
7. To lower load, raise load until pin in piston tube can be removed. Then SLOWLY lower load until lifting saddle is clear of load and remove pin in lifting saddle.

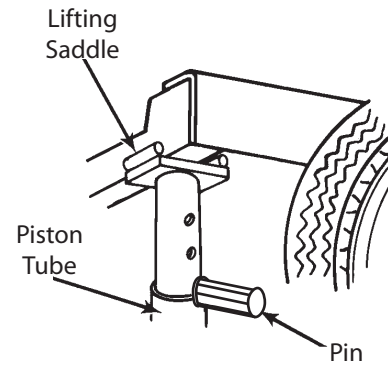

Figure 1.

## Maintenance

**IMPORTANT: Water entering the jack from the air supply or through the top cover plate can collect in the bottom of the cylinder, and result in rust buildup on the cylinder wall. Drain water out of the jack on a regular basis by removing the 45° elbow fitting at the base of the cylinder, and tilting the jack until all the water is removed.**

1. Lubricate the wheel shafts and center tube as needed with a high quality grease.
2. Inspect the air lift jack before each use. Keep the control valve and fittings clean. Keep the surface of the lifting saddle clean to ensure sufficient grip during a lift.
3. Periodically check the inlet air filter for debris. Clean or replace the filter when necessary.