



655 EISENHOWER DRIVE
 OWATONNA, MN 55060 USA
 PHONE: (507) 455-7000
 TECH. SERV.: (800) 533-6127
 FAX: (800) 955-8329
 ORDER ENTRY: (800) 533-6127
 FAX: (800) 283-8665
 INTERNATIONAL SALES: (507) 455-7223
 FAX: (507) 455-7063

**Parts List &
 Operating Instructions for:**

00002-07020
 7020
 ADCE-7020

D-01006-AA
 KTC-10601
 MEL-10268

Bench-Mounted Holding Fixture

Max. Capacity: 250 lbs.

Item No.	Part No.	No. Req'd	Description
1	34607	1	Base Assembly
2	34310-BL2	2	Arm
3	28890	1	Strap
4	10080	2	Hex Hd. Cap Screw (1/2-13 x 1-1/4" lg.)
5	10099	2	Hex Hd. Cap Screw (5/8-11 x 1-1/2" lg.)
6	34309	1	Pivot

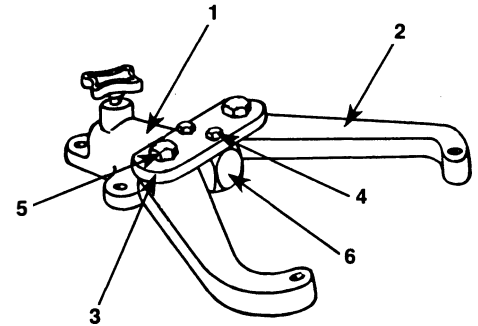

Safety Precautions



Caution: To help prevent personal injury,

- Do NOT work on a component unless the retaining knob is securing the pivot assembly in place. If the retaining knob is not in place, the pivot assembly will separate from the base assembly, possibly causing personal injury and/or damage to the component.
- Stay out from underneath the holding fixture.

1. Select a work surface capable of supporting at least 250 lbs.
2. Attach the Bench-Mounted Holding Fixture to the work surface using three 1/2" dia. bolts fastened with washers and nuts under the bench. See Figure 1.

Setup

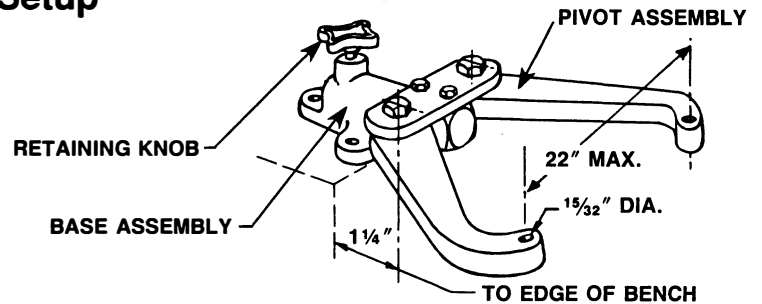

FIGURE 1

Attaching bolts must be strong enough to support the weight of the work piece.

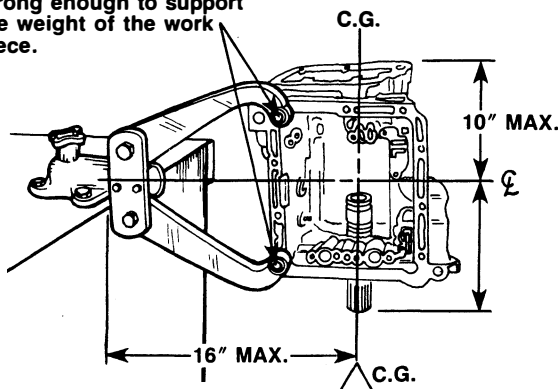

FIGURE 2

Operation

1. Attach the component to the holding fixture. See Figure 2.

Note:

- The component cannot weigh more than 250 lbs.
 - The component's center of gravity cannot be more than 16" from the face of the bench and not more than 10" off-center from the center line of the holding fixture.
 - The bolts used to fasten the component to the holding fixture must be strong enough to support the component.
2. Pull up on the spring-loaded retaining knob to rotate the component up to 360° with positive stops at 90° increments.
 3. To remove the pivot assembly, pull up on the retaining knob and turn it 90°. This disengages the pivot assembly so it can be pulled out of the base assembly.

Optional Head Mounting Fixture

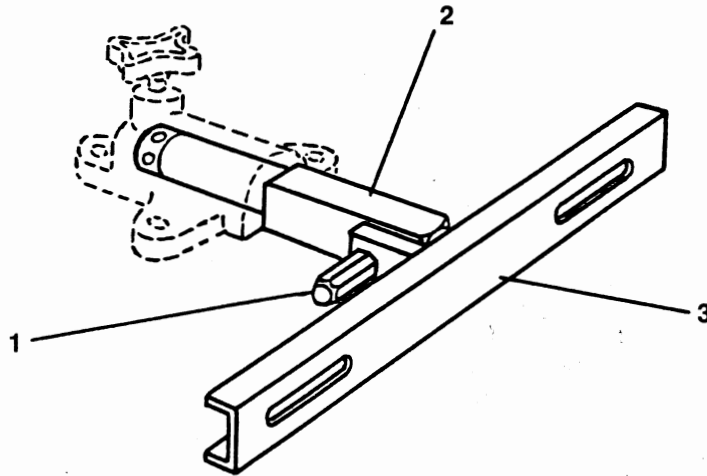

Item No.	Part No.	No. Req'd	Description
1	29206	1	Lock Screw
2	34504	1	Pivot
3	41544	1	Head Holder