



655 Eisenhower Drive
 Owatonna, MN 55060 USA
 Phone: (507) 455-7000
 Tech. Serv.: (800) 533-6127
 Fax: (800) 955-8329
 Order Entry: (800) 533-6127
 Fax: (800) 283-8665
 International Sales: (507) 455-7223
 Fax: (507) 455-7063

Form No. 538289

**Parts List &
 Operating Instructions for:**

1726A

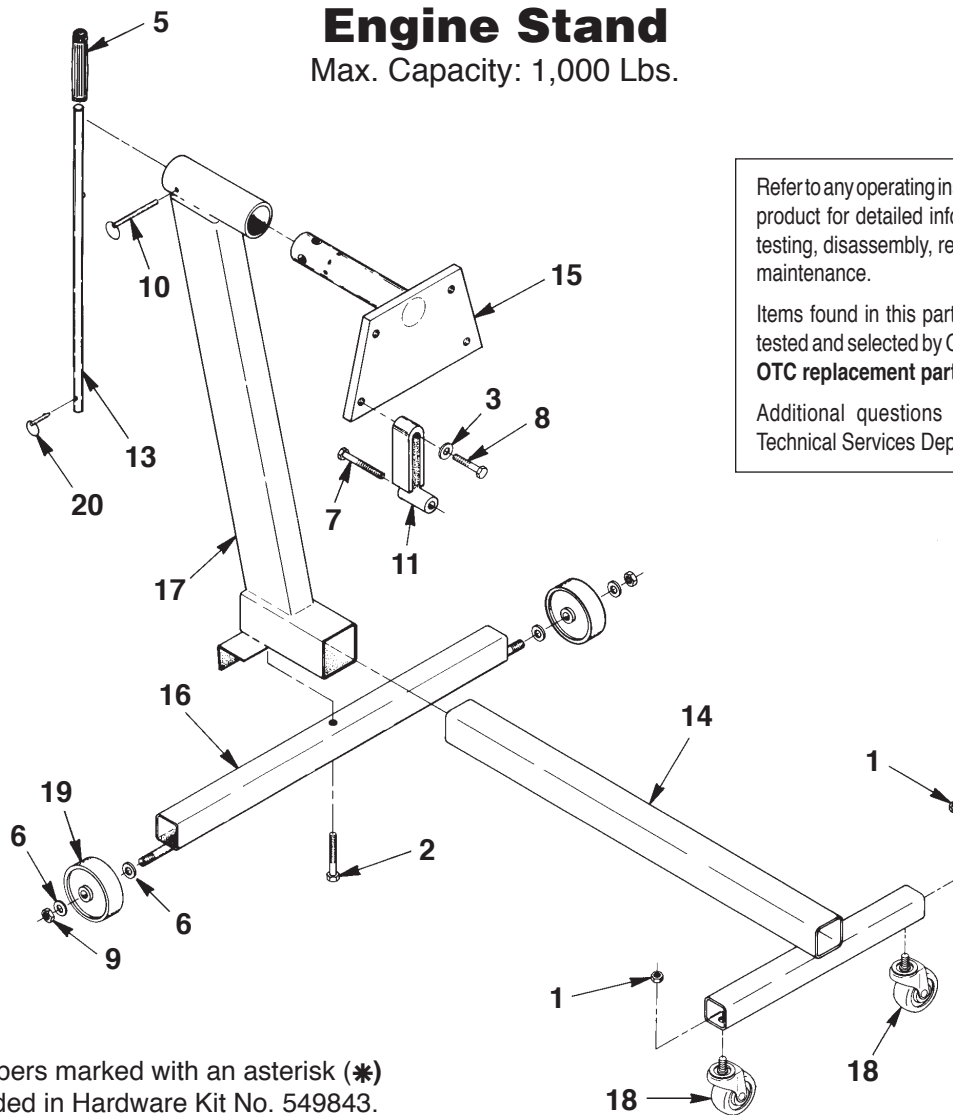

Engine Stand
 Max. Capacity: 1,000 Lbs.

Refer to any operating instructions included with the product for detailed information about operation, testing, disassembly, reassembly, and preventive maintenance.

Items found in this parts list have been carefully tested and selected by OTC. **Therefore: Use only OTC replacement parts!**

Additional questions can be directed to our Technical Services Dept. at 1-800-533-6127.

Part numbers marked with an asterisk (*) are included in Hardware Kit No. 549843.

Item No.	Part No.	No. Req'd	Description
1	*	2	Nut
2	*	1	Hex Hd. Cap Screw
3	*	4	Washer
5	540571	1	Handle Grip
6	*	4	Washer
7	*	4	Hex Hd. Cap Screw (3/8-16)
	*	4	Hex Hd. Cap Screw (7/16-14)
8	*	4	Hex Hd. Cap Screw
9	*	2	Lock Nut
10	*	1	Cotterless Hitch Pin
11	537155	4	Mounting Bracket
13	537156	1	Turning Bar

Item No.	Part No.	No. Req'd	Description
14	537187	1	Leg
15	537157	1	Mounting Plate
16	537186	1	Axle Tube
17	537188	1	Upright Post
18	540568	2	Swivel Caster
19	540569	2	Wheel
20	*	1	Cotterless Hitch Pin
Parts Included but not Shown			
	220028	1	Caution Decal
	537154	1	Trade Name & Capacity Decal
	206182	1	Instruction Decal

Safety Precautions



⚠ WARNING: To prevent personal injury,

- Study, understand, and follow the safety precautions and operating instructions included with this equipment. If the operator cannot read these instructions, the safety precautions and operating instructions must be read and discussed in the operator's native language.
- Wear eye protection that meets ANSI Z87.1 and OSHA standards.
- To maintain shear strength specifications, use grade 5 cap screws to mount adapters or engines.
- Tapped holes in adapters and engine blocks must be clean and not damaged to ensure full thread engagement. A thread length engagement equal to 1½ screw diameters minimum is required to maintain strength requirements.
- Do not exceed the 1,000 lb. maximum capacity of this engine stand. (Maximum capacity is determined with the center of the engine located not more than 18" from the engine stand mounting hub surface.)
- Stay out from underneath a load being lifted or suspended.
- The engine must be securely mounted on the repair stand with the hitch pin and turning bar in place and all mounting hardware torqued to specified values.

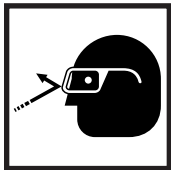

Assembly

(Numbers in parentheses refer to the items on the parts list.)

1. Place the upright post (17) on the floor.
2. Position the axle tube (16) against the angle iron bracket on the base of the upright post, aligning the bolt holes. Insert the hex hd. cap screw (2) through the holes far enough to connect the two pieces.
3. Insert the front leg (14) into the hollow base of the upright post. Tighten the cap screw (assembled in step 2) until it travels completely through the tube, post, and leg, and all three parts are securely fastened together.
4. Attach the swivel casters (18) and nuts (1) to the front leg. Tighten the nuts.
5. Assemble the following parts on each end of the axle in the order listed: washer (6), wheel (19), washer (6), locknut (9).
6. Slide the tubular end of the mounting plate (15) into the cylindrical top of the upright post. Install the hitch pin (10) and turning bar (13) through the post and mounting plate. Secure with the cotterless hitch pin (20).
7. Use cap screws (8) and washer (3) to loosely attach the four mounting brackets (11) to the mounting plate.

Operating Instructions

Mounting the Engine to the Engine Stand

1. Determine the engine's center of gravity.
2. Remove the engine clutch bell housing.
3. Remove the mounting plate (with brackets loosely attached) from the engine stand. Using either the 3/8" or 7/16" cap screws, fasten the four brackets to the engine. Do not tighten the screws.
4. Position the mounting plate axis of rotation as close as possible to the engine's center of gravity.
5. Tighten the four cap screws holding the brackets to the engine; tighten the four cap screws holding the brackets to the mounting plate.
6. Attach an engine lifting bar or sling to the engine. Using a suitable lifting device, maneuver the engine toward the stand.
7. Insert the tubular end of the mounting plate into the stand. Install the hitch pin and turning bar, and torque the mounting hardware to specified values. Slowly and carefully remove the engine lifting device.
8. Tighten the locknuts to lock the wheels and make the engine stand immobile before servicing the engine.

Removing the Engine from the Engine Stand

1. Attach an engine lifting bar or sling suspended from a suitable lifting device to the engine.
2. Remove the turning bar and hitch pin from the engine stand, and slowly pull the mounting plate out of the engine stand.
3. Maneuver the engine away from the engine stand, and unscrew the four cap screws holding the mounting bracket to the engine.

Preventive Maintenance: Periodically clean and lubricate the wheels, casters, and tubular end of the mounting plate. (Use a low temperature grease.)