



655 EISENHOWER DRIVE  
 OWATONNA, MN 55060-0995 USA  
 PHONE: (507) 455-7000  
 TECH. SERV.: (800) 533-6127  
 FAX: (800) 955-8329  
 ORDER ENTRY: (800) 533-6127  
 FAX: (800) 283-8665  
 INTERNATIONAL SALES: (507) 455-7223  
 FAX: (507) 455-7063

Form No. 554055

**Parts List &  
 Operating Instructions**  
 for:

**553516**

## Differential Mounting Adapter

Use with:

- OTC No. 5019A, 5078, or 1522A Transmission Jack for removal and installation of differential assemblies.
- OTC No. 5130 DriveMaster™ Driveline Lift for removal and installation of driveline components.

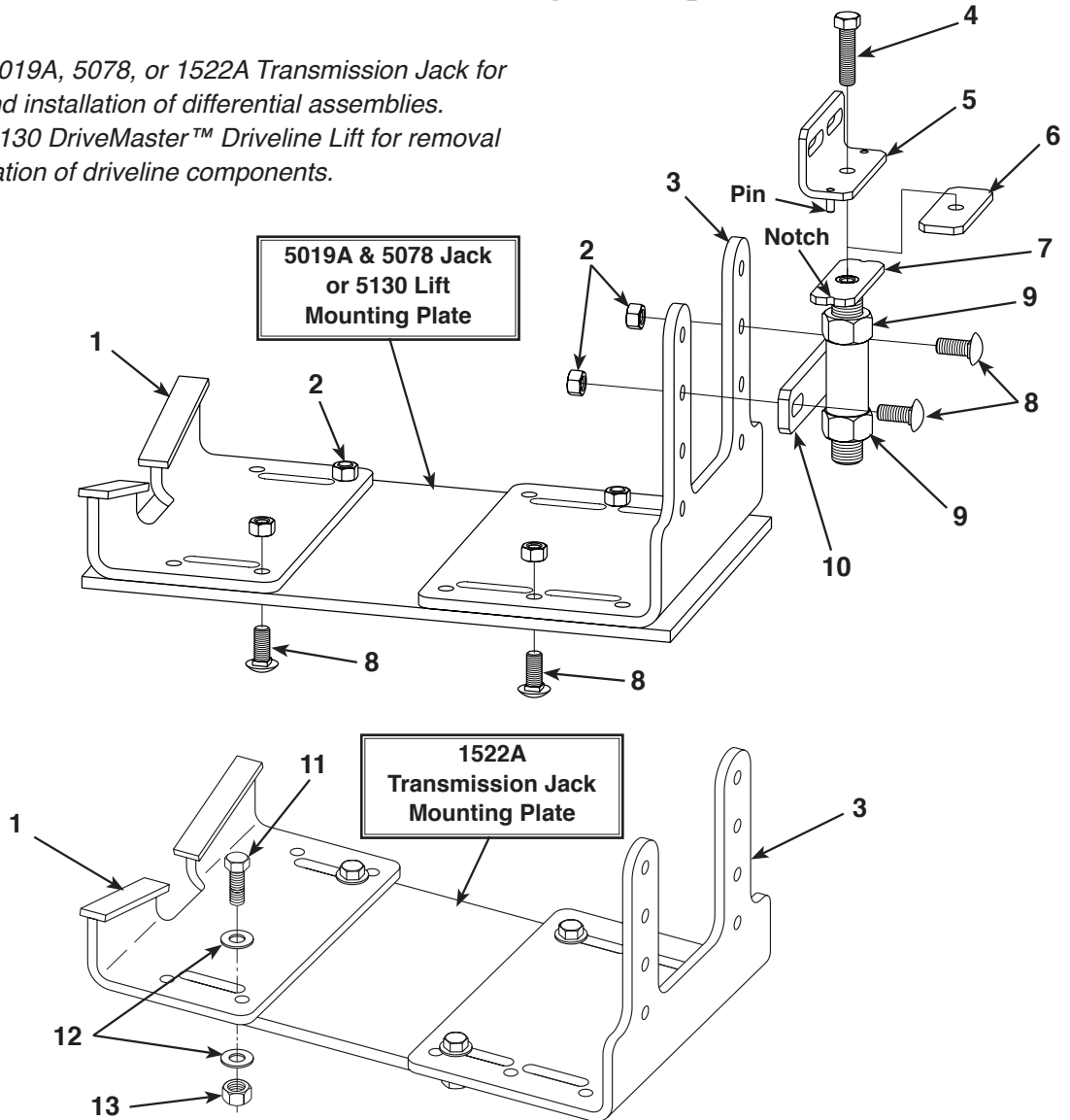

**Repair Kit No. 568560 contains:**

Item No.	Qty.	Description
2	6	Hex Nut (1/2-13)
4	1	Hex Head Cap Screw
8	6	Carriage Bolt (round head; square neck)
9	2	Hex Nut
11	4	Hex Hd. Cap Screw (9/16-12)
12	8	SAE Washer
13	4	Hex Nut (9/16-12)

**Parts List**

Item No.	Part No.	Qty.	Description
1	553358	1	Plate Weldment
3	553355	1	Plate
5	553360	1	Bent Clamp Assembly
6	553356	1	Top Clamp
7	553361	1	Support Screw Weldment
10	553359	1	Support Weldment

Sheet No. 1 of 2

Issue Date: Rev. D, March 18, 2013

**ASSEMBLY***(Item numbers refer to parts list.)*

1. Determine if the differential has removable end caps, and follow the appropriate procedure.

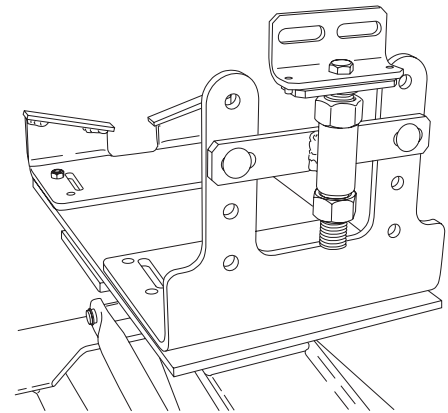
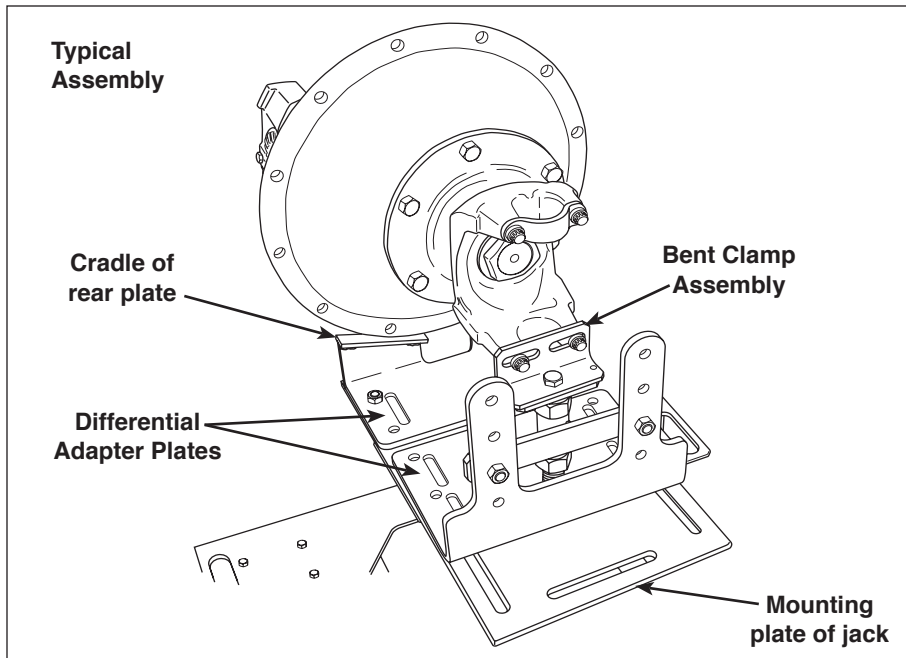
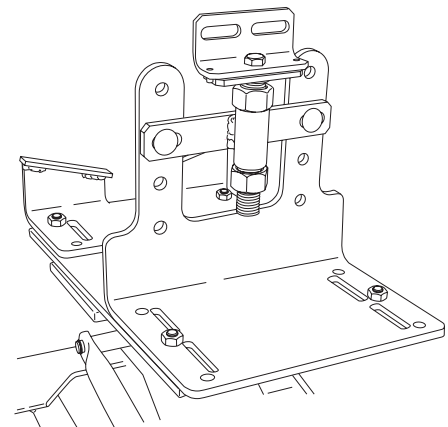
**If the Differential Has Removable End Caps****Alternate Assemblies**

1. Remove the lowest end cap from the yoke of the differential.
2. Position the jack under the differential.
3. **If using a 5019A or 5078 jack or the 5130 lift:** Loosely assemble the adapter plates (Item Nos. 1 and 3) to the mounting plate of the jack using hex nuts and carriage bolts (Nos. 2 and 8, four each). Orient and space the adapter plates to fit the shape of the differential as closely as possible.  
**If using a 1522A jack:** Loosely assemble the adapter plates (Items Nos. 1 and 3) to the mounting plate of the jack using four hex head cap screws (No. 11), eight washers (No. 12), and four nuts (No. 13). Orient and space the adapter plates to fit the shape of the differential as closely as possible.
4. Assemble the support screw weldment (No. 7) and bent clamp assembly (No. 5) to the support weldment (No. 10) as follows:
  - a. Thread a hex nut (No. 9) onto the support screw (No. 7), and insert the screw into the housing on the support weldment (No. 10). Thread the other hex nut (No. 9) onto the bottom of the screw.
  - b. Attach the bent clamp assembly (No. 5) to the support screw weldment (No. 7) using a hex head cap screw (No. 4). *Note: The pins on the bent clamp fit into notches on the support screw weldment.*
5. Using hex nuts and carriage bolts (Nos. 2 and 8, two each), attach the support weldment assembly to the pair of holes in the plate (No. 3) that best align the bent clamp assembly to the yoke of the differential.
6. Adjust the hex nuts on the support screw up or down as needed to further align the bent clamp assembly to the yoke.
7. Verify the alignment of the adapters with the differential, and secure all bolts and screws.
8. Close the control valve on the jack or lift. Operate the pump handle to raise the boom and align the adapter plates with the differential. The flange of the differential must rest on the cradle of the rear plate as shown in the "Typical Assembly" graphic.
9. Adjust the front plate / support screw assembly, if necessary, until the bent clamp assembly aligns with the yoke of the differential. Attach the clamp to the yoke using the bolts from the yoke end cap.
10. Remove the differential from the vehicle according to the instructions in the vehicle service manual.

## If the Differential Does Not Have Removable End Caps

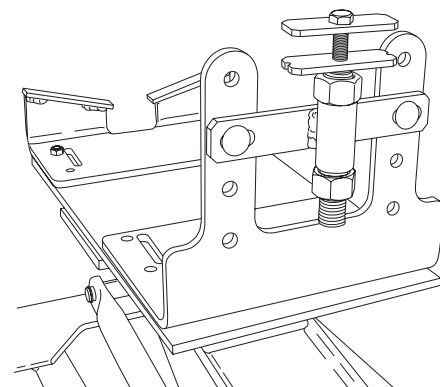
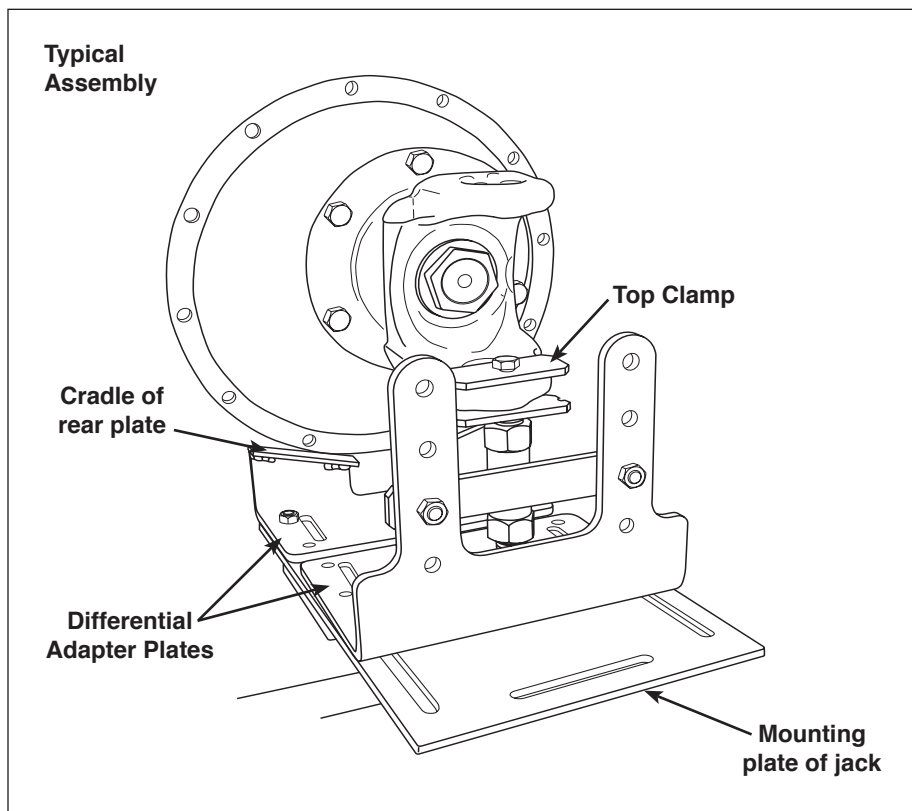

Alternate Assemblies

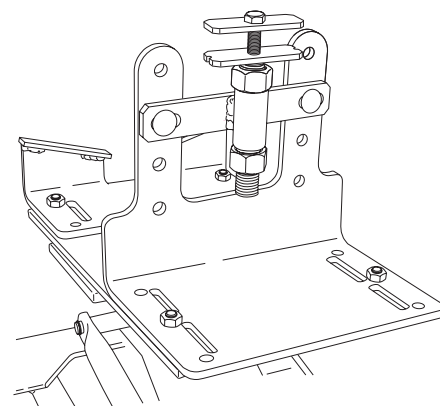

- 1 Position the jack under the differential.
2. **If using a 5019A or 5078 jack or the 5130 lift:** Loosely assemble the adapter plates (Item Nos. 1 and 3) to the mounting plate of the jack using hex nuts and carriage bolts (Nos. 2 and 8, four each). Orient and space the adapter plates to fit the shape of the differential as closely as possible.  
**If using a 1522A jack:** Loosely assemble the adapter plates (Items Nos. 1 and 3) to the mounting plate of the jack using four hex head cap screws (No. 11), eight washers (No. 12), and four nuts (No. 13). Orient and space the adapter plates to fit the shape of the differential as closely as possible.
3. Thread a hex nut (No. 9) onto the support screw (No. 7), and insert the screw into the housing on the support weldment (No. 10). Thread the other hex nut (No. 9) onto the bottom of the screw.
4. Using hex nuts and carriage bolts (Nos. 2 and 8, two each), attach the support weldment assembly to the pair of holes in the plate (No. 3) that best suits alignment with the yoke of the differential.
5. Adjust the hex nuts on the support screw up or down as needed to further align with the yoke.
6. With the hole in the yoke of the differential aligned over the support screw, attach the top clamps (No. 6) to the support screw weldment (No. 7) using a hex head cap screw (No. 4).
7. Verify the alignment of the adapters with the differential, and secure all bolts and screws. Lock the hex nuts on the support screw.
8. Close the control valve on the jack or lift. Operate the pump handle to raise the boom and align the adapter plates with the differential. The flange of the differential must rest on the cradle of the rear plate as shown in the "Typical Assembly" graphic.
9. Adjust the front plate / support screw assembly, if necessary, until the yoke of the differential is supported by the support screw and the top clamp holds the yoke firmly in place.
10. Remove the differential from the vehicle according to the instructions in the vehicle service manual.